

The Cigar Factory

SOUTHVILLE

APPROXIMATE FLOOR AREA
45 SQM / SQFT 480



GROUND FLOOR

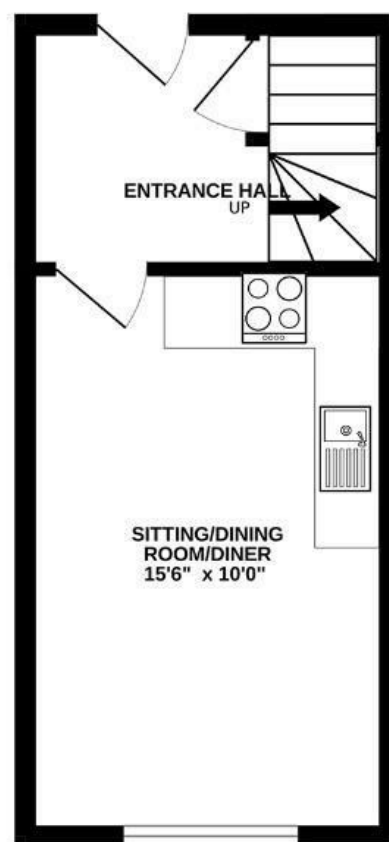

FIRST FLOOR

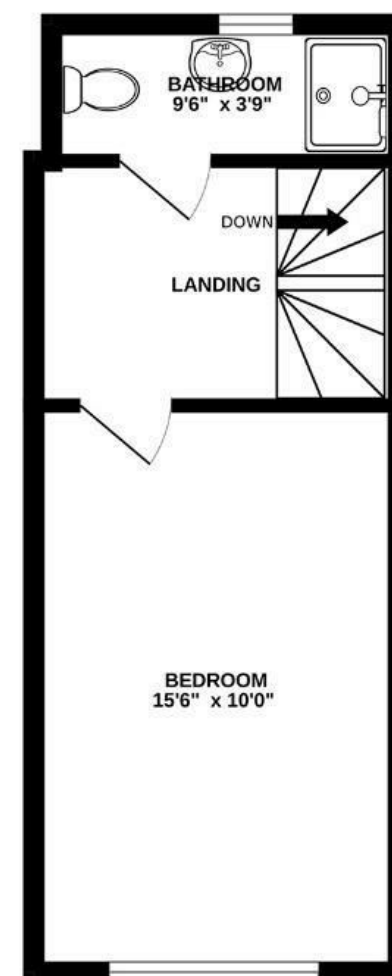

Boardwalk

Raleigh Road , BRISTOL

£

£220,000



BS3 1QU

zzz

1 Bedrooms



1 Bathrooms

"Everything you need is on the doorstep. I like the Tobacco Factory market on a Sunday which is right outside. I like the view of the suspension bridge. All of the restaurants on North Street take two minutes to walk to and having Aldi right opposite saves a lot of money and time. It is also very easy to walk into Ashton Court and Whapping Wharf."

